

8 Thorn House, 279 Wilmslow Road, Rusholme, Manchester, M14 6DW



JP&Brimelow
ESTATE AGENTS

Offers In The Region Of £160,000



CURRENTLY TENANTED A well-presented and spacious TWO DOUBLE BEDROOM apartment within this sought after development positioned off Wilmslow Road. Offering excellent access to Manchester City Centre, Universities, Manchester Airport and the surrounding areas of Withington and Chorlton through the biggest bus network in Europe, along the Wilmslow Road corridor. The well-planned accommodation comprises; communal entrance hallway with stairs leading to all floors. A private entrance hallway with useful storage cupboards. A lounge leading to a dining area and fitted kitchen, two double bedrooms with fitted cupboards and a four-piece bathroom suite. The apartment benefits from well-maintained lawned gardens, residential parking and moments from Platt Fields Playing fields. Internal viewing essential to appreciate this fantastic apartment. OFFERED WITH NO VENDOR CHAIN.





EPC Chart

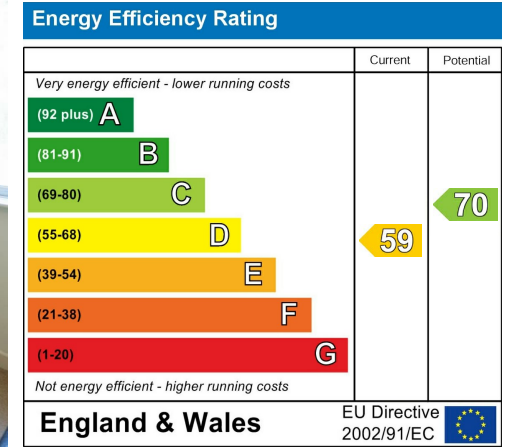

Tenure: **Leasehold** Council Tax Band: **C**

Second Floor

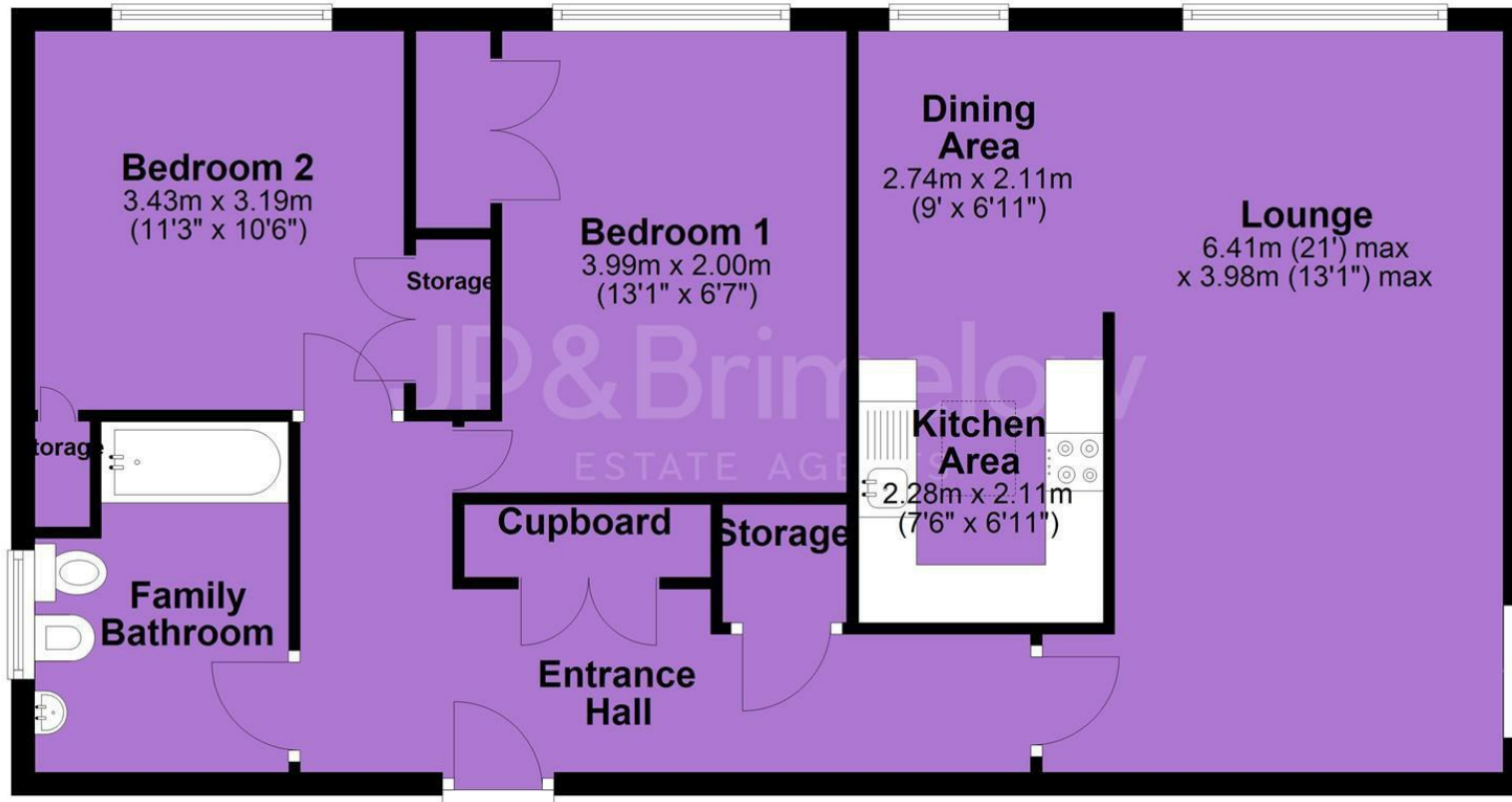

JP & Brimelow Estate Agents Ltd
430 Barlow Moor Road, Manchester, M21 8AD
Tel: 0161 8822233
E: sales@jpbrimelow.co.uk www.jpandbrimelow.co.uk

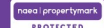

JP & Brimelow
ESTATE AGENTS

NOTICE: JP & Brimelow Estate Agents Ltd for themselves and for the vendors or lessors of this property whose agents they are give notice that:

- the particulars are set out as a general outline only for the guidance of intending purchasers or lessees, and do not constitute, nor constitute part of, an offer or contract;
- all descriptions, dimensions, references to the condition and necessary permissions for use and occupation, and other details are given in good faith and are believed to be correct but any intending purchasers or tenants should not rely on them as statements or representations of fact but must satisfy themselves by inspection or otherwise as to the correctness of each of them;
- no person in the employment of JP & Brimelow Estate Agents Ltd has any authority to make or give any representation or warranty whatever in relation to this property.

jpandbrimelowstateagents

@jpandbrimelow